



# 2025 Artomatic 419

## Spectacle Art Location Photos



# Area 1

Main Entryway - Right





# Area 2

Main Entryway - Left





# Area View First Room





# Area 3





# Area 4





# Area 4

Inside Right Side





# Area 4

Inside Left Side





# Area 5

Three of the center panels open, the first, middle, and last





# Area 6

Main floor or planter





# Area 6 & 7

6 - Main floor or planter  
7 - entryway to other bay, this bay will not be in use so we will be blocking these doors





# Area 8





# Area 9





# Area View - Hallway





# Area 10





# Area 11





# Area 10/11 Ceiling View





# Area 12





# Area 13





# Area 12/13 Ceiling View





# Area 14

Entry to Exhibition Area





# Area 15

Entry to Film Room





# Area 16

Ceiling of Film Room  
\*Installation must be above  
lights





# Area 17





# Area 17 Alternate View





# Area 18





# Area 17/18 Ceiling View





# Area 17/18 Ceiling View (2)





# Area 19

Literary Performance Area

\* Installations must be well above head height of the space to have room for performances and an audience





# Areas 14 - 19 Ceiling View





# Areas 14 - 19 Alternate View





# Area 20

Exhibition Area Entry/Exit Side  
\*Installations must be hanging  
10' from the ground at the  
lowest point





# Area 21

\*Installations must be hanging  
10' from the ground at the  
lowest point





# Exhibition Area Ceiling View

\*Installations must be hanging  
10' from the ground at the  
lowest point





# Area 22

\*Installations must be hanging  
10' from the ground at the  
lowest point





# Area 23

Left Side

\*Installations must be hanging  
10' from the ground at the  
lowest point





# Area 24

Right Side

\*Installations must be hanging  
10' from the ground at the  
lowest point





# Exhibition Area Right View

\*Installations must be hanging  
10' from the ground at the  
lowest point





# Exhibition Area Center View

\*Installations must be hanging  
10' from the ground at the  
lowest point





# Exhibition Area Left View

\*Installations must be hanging  
10' from the ground at the  
lowest point





# Exhibition Area

View from Garage

\*Installations must not obstruct view





# Exhibition Area

View from Garage Entry  
\*Installations must be hanging  
10' from the ground at the  
lowest point





# Area map

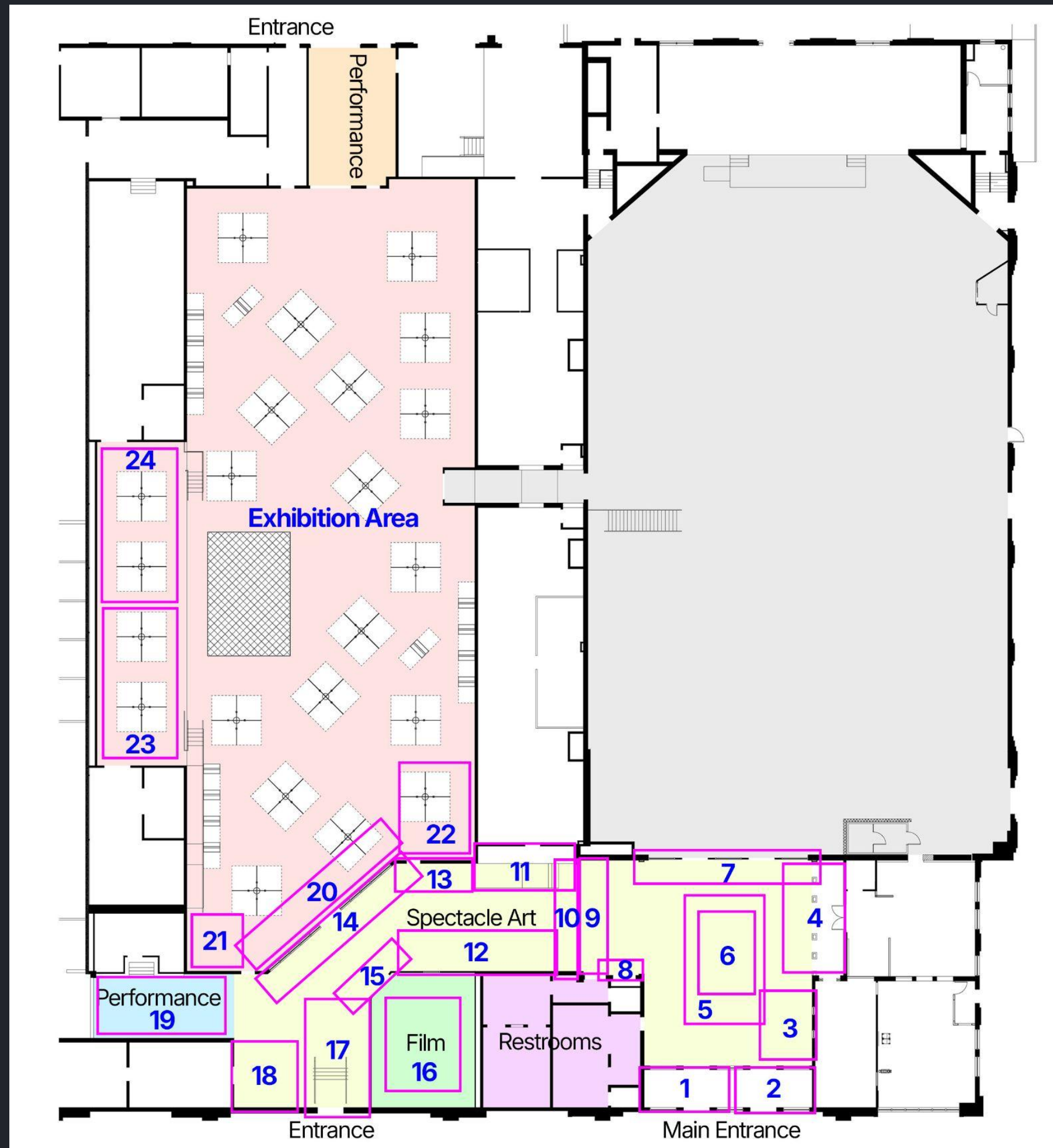



# Submit Your Proposal Here:

<https://theartscommission.wufoo.com/forms/2025-artomatic-419-spectacle-art-call/>

Contact Tess Healy with any questions:

419.254.2787 x1017

[thealy@theartscommission.org](mailto:thealy@theartscommission.org)

theartscommission.org

---

